

ML-IGF

POZZETTI - GELATO / ICE-CREAM DISPLAY FREEZER

DESCRIPTION OF STANDARD UNIT:

- Gravity cooling
- Finishing elements of stainless steel
- Device adapted for furniture installation (assembly on a worktop)
- Stainless steel worktop
- White lighting
- Gelato pans
- Temp. range*: -12 ÷ -24°C
- Automatic defrosting
- Automatic water Evaporation
- Digital temperature control



OPTIONS:

- Wheels
- Spoon washer
- For individual decoration
- Glass extension

* Temperature range given for max ambient temp of +30°C and relative humidity of 55%.
 ** Cooling power demand: 400 W/1mr at evaporating temp. -10°C (Hawana W); 350W/1mr at evaporating temp. -25°C
 *** We reserve the right to modify or change the technical specifications of the product without prior notice.

MODEL	LENGTH	DEPTH	HEIGHT	QTY OF PANS	WEIGHT (LBS / KG)	ELECTRICAL
ML4-IGF	30 1/2"	29 3/4"	45 1/4"	4	341 / 155	115V / 60Hz / 1ph / 5 AMP
ML6-IGF	39 3/4"	29 3/4"	45 1/4"	6	385 / 175	115V / 60Hz / 1ph / 6 AMP
ML8-IGF	49 1/4"	29 3/4"	45 1/4"	8	451 / 205	115V / 60Hz / 1ph / 7 AMP

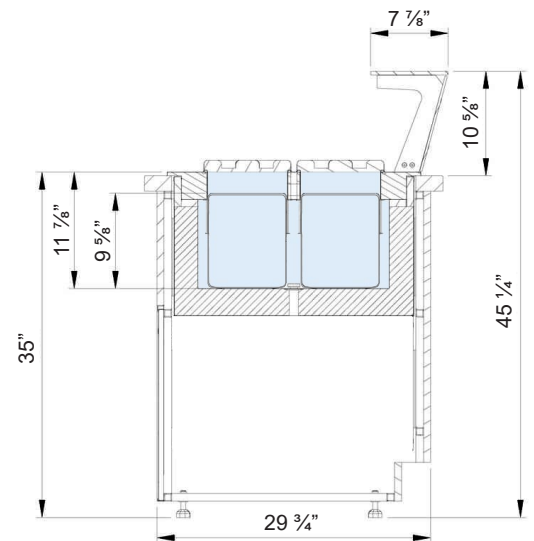

Available Colors

