

PR-RDM

DUAL SERVICE REFRIGERATED DISPLAY

DESCRIPTION OF STANDARD UNIT:

- Refrigerated version
- Refrigerant R290
- LED lighting (Warm white)
- Construction of powder coated steel
- Sliding Plexiglas doors for the upper section
- Double glazed side glass
- Stainless steel interior
- Forced cooling
- Temp. range*: 0 ÷ +4°C
- Automatic water Evaporation
- Front glass secured by string cable
- Front opening glass
- Digital temperature control

OPTIONS:

- Heated version: Natural lower part and heated upper part
- Neutral version: Neutral lower and upper part
- For external condensing unit
- Wheels

* - Values are provided for an ambient temp of +25°C and relative humidity of 60%.
 ** - Cooling power demand: 1000 W/1m³ at evaporating temp. -10°C.



SPECIFICATIONS					
MODEL	LENGTH	DEPTH	HEIGHT	WEIGHT (LBS / KG)	ELECTRICAL
PR3-RDM	39 1/2"	40 1/2"	53"	551 / 250	115V / 60Hz / 1ph / 12 AMP

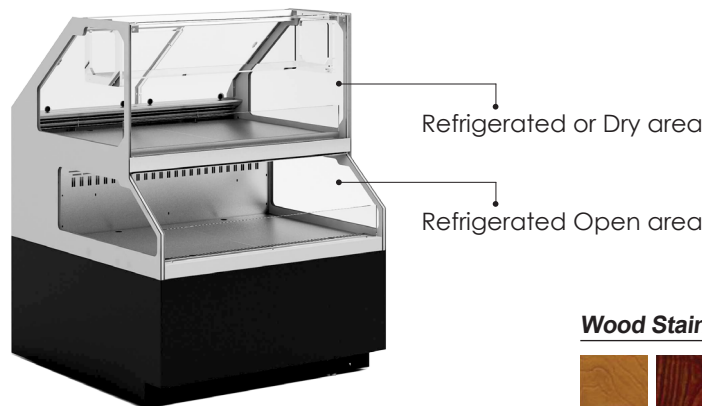
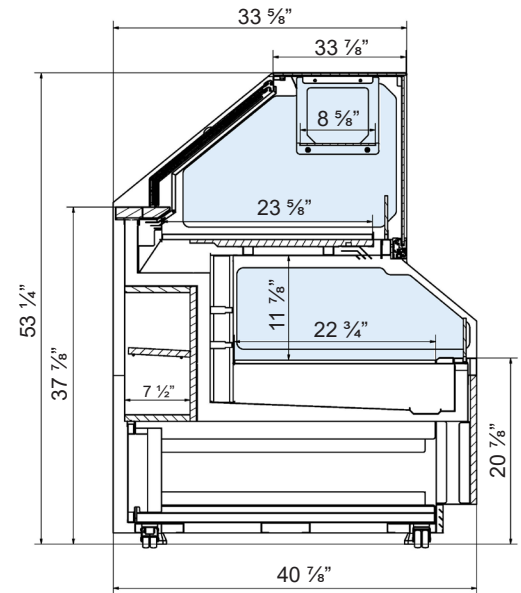

Profile Colors



Wood Stains

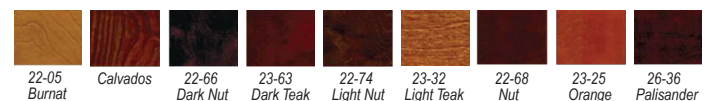

Available Colors

