

TSS-ROM

REFRIGERATED OPEN MERCHANDISER

DESCRIPTION OF STANDARD UNIT:

- Construction of powder coated steel
- Finishes in stainless steel or powder coated steel
- Double side glass with PCV finishing
- Perforated stainless steel back panel
- Highlighted (LED) and adjustable stainless still shelves
- Controller on the front or back
- Access to the condenser from the front
- Price strips
- Tempered glass
- Forced cooling
- Temp. range*: 0 ÷ +4°C
- Automatic defrosting
- Automatic water evaporation



OPTIONS:

- Multiplexing
- Version for external condensing unit
- Stainless steel shelves & base decks
- Light plafond
- Night blind
- Wheels



SPECIFICATIONS					
MODEL	LENGTH	DEPTH	HEIGHT	WEIGHT (LBS / KG)	ELECTRICAL
TSS2-ROM	23 5/8"	29 1/2"	54 3/4"	198 / 90	115V / 60Hz / 1ph 8 AMP
TSS3-ROM	35 1/2"		54 3/4"	253 / 115	115V / 60Hz / 1ph 9.5 AMP
TSS4-ROM	47 1/4"		54 3/4"	330 / 150	115V / 60Hz / 1ph 11.5 AMP

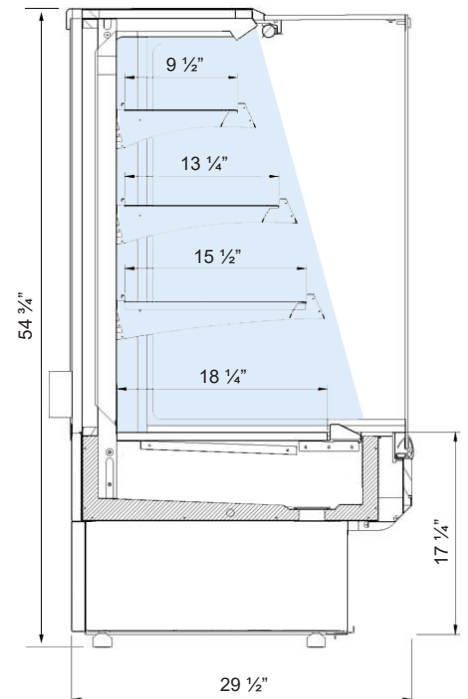

* Temperature range given for maximum ambient temperature of +25°C and relative humidity 60%.
 ** Cooling power demand: 1500 W/1m² at evaporating temp. -10°C. Automatic water evaporation on request.
 *** In version with doors: only top lighting

Wood Stains

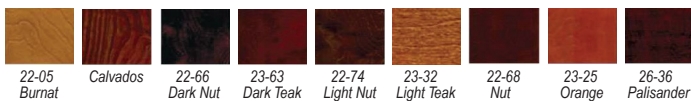

Available Colors

