

MG-RP

STRAIGHT FRONT GLASS REFRIGERATED DISPLAY CASE

DESCRIPTION OF STANDARD UNIT:

- 2 versions: Refrigerated (MG-R), Dry (MG-D)
- LED lighting
- Construction of powder coated steel
- Wooden casing
- Front, side and top glasses: single, with serigraphy (silver or black)
- Lift up system of front glass
- 3 rows of highlighted adjustable, glass shelves
- Yellow lighting
- Bottom decks on tray slides
- Sliding, double glass rear doors
- Wheels
- Forced cooling
- Temp. range* : 0 ÷ +4 °C
- Automatic water Evaporation
- Hygrostat (humidity reduction)
- Digital temperature control



OPTIONS:

- Version for chocolate & pralines
- For external condensing unit
- Ultrasonic humidifier
- External condensing unit
- Dry non refrigerated version MG-DP: (room temperature)

* - Values are provided for an ambient temp of +25°C and relative humidity of 60%.
 ** - Cooling power demand: 1000 W/1m³ at evaporating temp. -10°C.

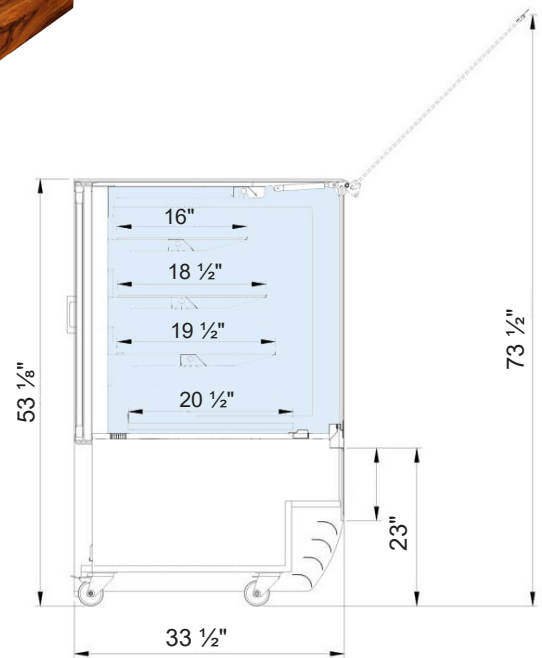

SPECIFICATIONS					
MODEL	LENGTH	DEPTH	HEIGHT	WEIGHT (LBS / KG)	ELECTRICAL
MG3-RP	37"	33 1/2"	53 1/8"	397 / 180	115V / 60Hz / 1ph / 9.5 AMP
MG4-RP	56 1/2"	33 1/2"	53 1/8"	618 / 280	115V / 60Hz / 1ph / 11.5 AMP



Profile Colors

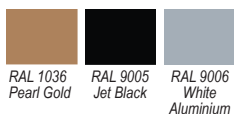

Granite Finishes

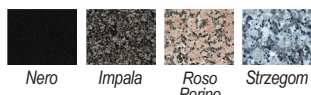

Wood Stains

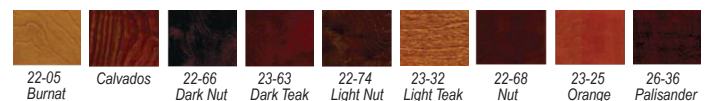

Available Colors

