

## LM-WDP

### NON-REFRIGERATED SQUARE GLASS DISPLAY CASE

#### DESCRIPTION OF STANDARD UNIT:

- 3 versions: Refrigerated (LM-R), Hot (LM-H), Dry (LM-D)
- LED lighting
- Construction of powder coated steel
- Wooden casing
- Side and front glasses: double with serigraphy (golden, silver or black)
- Finishes: golden, silver or black
- 3 rows of highlighted adjustable shelves: glass (LM-R, LM-D) or stainless steel (LM-H)
- Yellow lighting
- Sliding, double glass rear doors
- Temp. range: room temperature
- Temp. range for LM-R: 0 ÷ +4°C
- Front glass secured by string cable
- Front opening glass



#### OPTIONS:

- Version for pastry, chocolate & pralines
- Wheels
- Stainless steel worktop
- For individual decoration
- Multiplexing
- Flap doors on the front
- Highlighted front

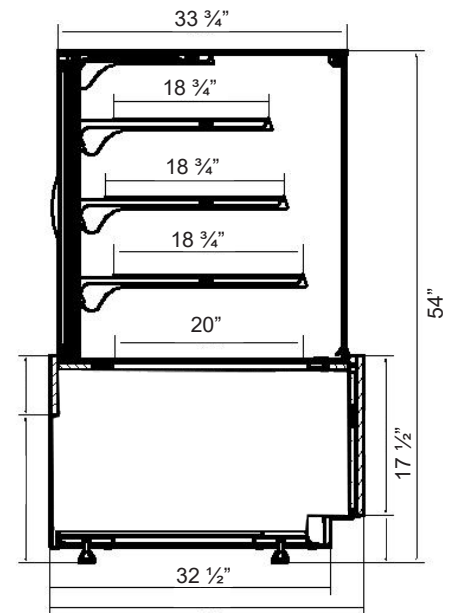

#### SPECIFICATIONS

MODEL	LENGTH	DEPTH	HEIGHT	WEIGHT (LBS / KG)	ELECTRICAL
LM2-WDP	25 1/4"	32 1/2"	54"	80 / 176	115V / 60Hz / 1ph / 1 AMP
LM3-WDP	37"	32 1/2"	54"	120 / 265	115V / 60Hz / 1ph / 2 AMP
LM4-WDP	53"	32 1/2"	54"	190 / 419	115V / 60Hz / 1ph / 2 AMP
LM6-WDP	71 1/4"	32 1/2"	54"	836 / 380	115V / 60Hz / 1ph / 4 AMP



#### Profile Colors

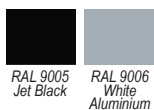

#### Granite Finishes

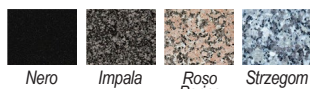

#### Wood Stains

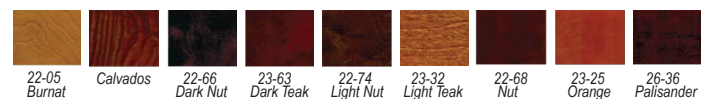

#### Available Colors

