

## JK-SSD

### STRAIGHT FRONT GLASS SALAD DISPLAY CASE

#### DESCRIPTION OF STANDARD UNIT:

- Construction of powder-coated steel
- LED lighting
- Front & sides panel made of stainless steel, or MDF (custom).
- Refrigerated storage chamber
- Highlighted glass top
- Stainless steel worktop
- Forced cooling
- Temp. range\*: 0 °C ÷ +4 °C
- Automatic defrosting
- Automatic water Evaporation
- Digital temperature control

#### OPTIONS:

- Granite top
- Colors of choice
- Wooden casing
- Heated version
- Wheels



\* Temperature range given for max ambient temp of +30°C and relative humidity of 55%.  
 \*\* Cooling power demand: 400 W/1mr at evaporating temp. -10°C (Hawana W); 350W/1mr at evaporating temp. -25°C

#### SPECIFICATIONS

MODEL	LENGTH	DEPTH	HEIGHT	PANS	WEIGHT (LBS / KG)	ELECTRICAL
JK2-SSD	37 ¾"	27 ¾"	33 ½"	2	330 / 150	115V / 60Hz / 1ph / 6 AMP
JK3-SSD	51 ¼"	27 ¾"	33 ½"	3	352 / 160	115V / 60Hz / 1ph / 6.5 AMP
JK4-SSD	59 ¼"	27 ¾"	33 ½"	4	396 / 180	115V / 60Hz / 1ph / 7 AMP
JK5-SSD	73 ¾"	27 ¾"	33 ½"	5	440 / 200	115V / 60Hz / 1ph / 8 AMP
JK6-SSD	91 ½"	27 ¾"	33 ½"	6	485 / 220	115V / 60Hz / 1ph / 8.5 AMP

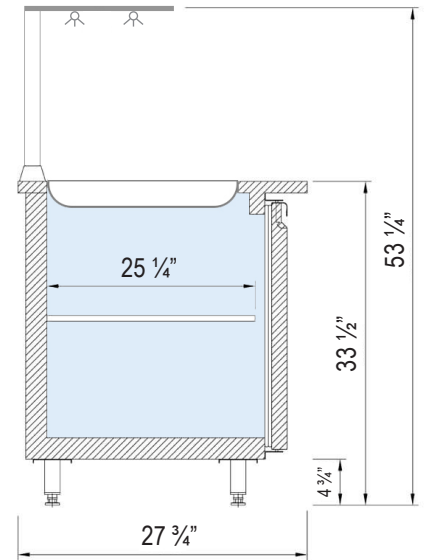

#### Wood Stains

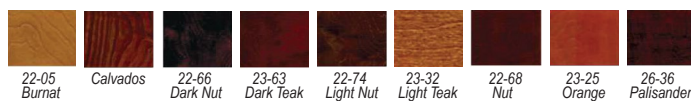

#### Granite Finishes

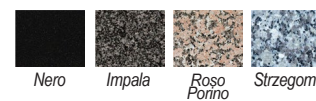

#### Available Colors

